

nSight™



Overview

nSight is a monochrome LCD data projector ideal for the educational, software training, and corporate markets for applications that require high-quality LCD projection of computer images at a low cost. Since the light source is designed into the unit, no overhead projector is required. nSight is used by teachers for projecting lesson outlines, by students and teachers for making computer-based presentations and by corporations and educational institutions for software training and presentations. In addition, the unit may be used as a low-stress "monitor" for individual or group computing. nSight is compact and can be carried easily from room-to-room and even on an airplane. The unit projects in 16 shades of gray and incorporates a double supertwist LCD with a resolution of 640 x 480 lines. nSight is compatible with practically any old or new computer. Because it uses a standard 35mm slide projector lens, users have the flexibility of substituting

their own existing lenses. The unit has a built-in control panel for focus, contrast and image positioning, as well as a wireless remote control device. Price includes the user's choice of one cable set.

Features

- Light source designed into unit makes set-up easier (no overhead projector required). Projected images are of consistent brightness.
- High contrast ratio and 640 x 480 resolution provide clear, high-quality images.
- Compact, rugged design with carrying handle, nSight can be hand-carried easily.
- Multisyncs to most existing IBM, Apple and Macintosh computers for flexibility.
- Features standard 35mm slide projector lens so user can substitute existing lenses.
- Built-in monitor redrive capability for viewing monitor and projected images simultaneously.

nSight™

Technical Specifications

nSight is compatible with the following computers and video modes:

- Mac 512, Mac Plus, Mac SE, Mac SE/30, Mac Classic, Mac LC, Mac Portable, Mac II, Mac IIx, Mac II ci, Mac IIsi, Mac II fx
- Apple IIc, Apple IIe, Apple IIgs (all in monochrome).
- IBM PC, AT, XT, PS/2 and compatible computers.
- VGA, EGA, CGA, Hercules/monochrome.

Liquid Crystal Display Type

Double Supertwist LCD, 640 x 480 pixels.

Display Format

640 x 480 pixels in VGA, or Mac II, Mac LC video modes.
640 x 400 pixels in CGA or composite (Apple II) video modes.
640 x 350 EGA video mode.

Mac II, Mac LC Monitor Requirements

Monitor with 640 x 480 resolution is required, such as 13" color monitor or 12" monochrome monitor.

Controls

Contrast, Focus, Shift, Position. On board control pad and infrared remote control device included.

Projection Lens

1:28, f=85mm

Dimensions

11" (front) x 12" (side) x 5.25" (height).

Weight

17 lbs.

Ambient Temperature

Operating: 0 C to +40 C. Storage: -20 C to + 50 C.

Humidity

Operating: 10% to 80%. Storage 10% to 90%.

Mean Time Between Failures

10,000 power-on hours (estimated)

Cables

nVIEW has cables for each video mode supported. User's choice of one cable set included in price.

Adapter Kits

Macintosh SE/SE30 Adapter Kit; Macintosh 512/Plus Adapter Kit; Macintosh Portable Adapter; Macintosh Classic Adapter Kit.

Accessories

Remote control, user's choice of one cable set included
TOTEBOARD® wireless keyboard for PC users is optional.

Warranty

One year limited warranty on parts and labor.

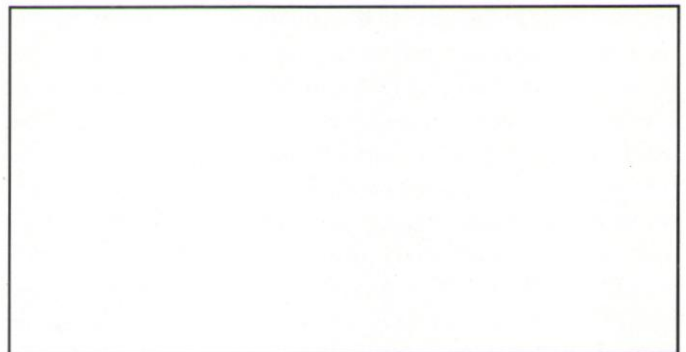

MediaPro™



Actual Image

Description

The MediaPro multiple source LCD projection panel is a lightweight, high-resolution, active-matrix liquid crystal display projection panel capable of projecting color images directly from up to four video sources concurrently. The MediaPro can project computer video, such as Mac II and VGA, and conventional video from sources such as VCRs, laser disc players, television receivers, and professional video cameras. Four separate sources can be connected at one time and played as desired by selection from the remote control wand. As a visual aid, MediaPro is particularly well-suited for business meetings, presentations, demonstrations, and group instruction.

When placed on an overhead projector and connected to video sources, the MediaPro acts as an electronic transparency. The MediaPro eliminates the need for multiple projection devices such as CRT-based data and video projectors, monitors, and wide screen televisions. For example, you can use the MediaPro to present a training videotape to an audience in the morning and conduct software training in the afternoon – in different rooms or even different countries. The MediaPro produces images in perfect color and is suitable for crisp animation, digitized photography, 3-D models, and live video.

Building on the proprietary electronics and firmware which

have earned previous nVIEW products 2 *PC Magazine* Editors' Choice awards, the MediaPro delivers superior performance and image quality. With a range of 32,000 colors and an active-matrix LCD, MediaPro projects images in rich, saturated, true color. As an integrated computer and conventional video projection panel, the MediaPro delivers superb image quality, versatility, and ease of use for your meetings and training sessions.

Features

- Over 32,000 rich, saturated colors for smooth, lifelike images.
- High contrast lends sharpness and realism to presentations.
- Removable control panel for remote or on-board adjustments and operation.
- Removable control wand can access additional controls from the MediaPro's pull-down menus.
- Capable of being controlled directly by computer, for automatic adjustments and for multimedia presentations using an authoring software.
- Front or rear projection capability.
- Advanced cooling for trouble-free operation.
- Compatible with worldwide video signal standards including Macintosh and IBM computer video, NTSC, PAL, and SECAM (optional.)
- Adjustments for each video source are saved in permanent memory for easy subsequent set up.

MediaPro™

Technical Specifications

The MediaPro multiple-source, high-resolution liquid crystal display projection panel is compatible with:

- IBM PS/2, PC, XT, AT, and compatible computers.
- Mac II Series computers.
- Mac LC.
- Video sources, such as laser disc players, cameras, and video cassette players.
- NTSC, PAL, SECAM (Optional) video sources.
- S-Video sources such as S-VHS and Hi8.
- Overhead projectors with light source below stage.

Display Type

Active-matrix, Thin Film Transistor Liquid Crystal Display,
640 x 480 x 3 pixels.

Display Format

8.31 x 6.24 inches (211.2 x 158.4 mm.)

1.3:1 Aspect Ratio.

60:1 (Minimum) Contrast Ratio.

640 x 480 pixels in VGA or Macintosh II video modes.

640 x 350 pixels in EGA video mode.

640 x 480 in video modes.

Controls

Remote Control Functions:

Source (1-4), Status, Menu, Focus, Contrast, Bright, Reset, Help, Curtain.

MediaPro Pull-Down Menu:

Color, Tint, Image Positioning, Master Reset, and others.

Materials

Heavy-gauge aluminum with non-skid rubber feet.

Protective optical surfaces on top and bottom.

Dimensions

15.8 x 12.7 x 2.6 inches (401.32 x 322.58 x 66.56 mm).

Weight

8.75 lbs.

Cooling

Patented cooling system uses a metal body, internal fans, and two active air layers to sustain continuous operation.

Power Supply

External UL, CSA, TUV approved international power supply.

Temperature

Operating: 0° C to + 49° C; storage: -25° C to +60° C.



Humidity

95% RH max for ambient temp. less than or equal to 40° C.

80% RH max for ambient temp. greater than 40° C.

Cables

VGA and Mac II computer video cables, 2 meters long, and Mac II monitor cable for simultaneous computer monitor viewing. (Not necessary for VGA.)

Video Input Connectors

RCA jack for composite (NTSC, PAL, SECAM)

MiniDin 4 Y/C (S-VHS, Hi8, NTSC, PAL, SECAM)

BNCs (5) Analog RGB (Video, VGA, Mac II)

Subminiature DB-9 (EGA)

Subminiature DB-15 (VGA, Mac II)

Video Output Connector

High Density DB-15 (drives computer monitor for simultaneous viewing.)

Utility Diskettes

Diskettes in both 3.5 and 5.25 inch formats provide a demonstration and utilities program.

Warranty

One year limited warranty on parts and labor.

Packaging

Each MediaPro includes manual, utility diskettes, universal power supply, hard shell carrying case, VGA and Mac II computer cables, and appropriate monitor cable. (Not required for VGA monitors.)

Accessories

Additional computer video interface cables, computer monitor cables, Projector Control Kits for overhead projector remote control, SECAM compatibility.

ViewFrame® Spectra

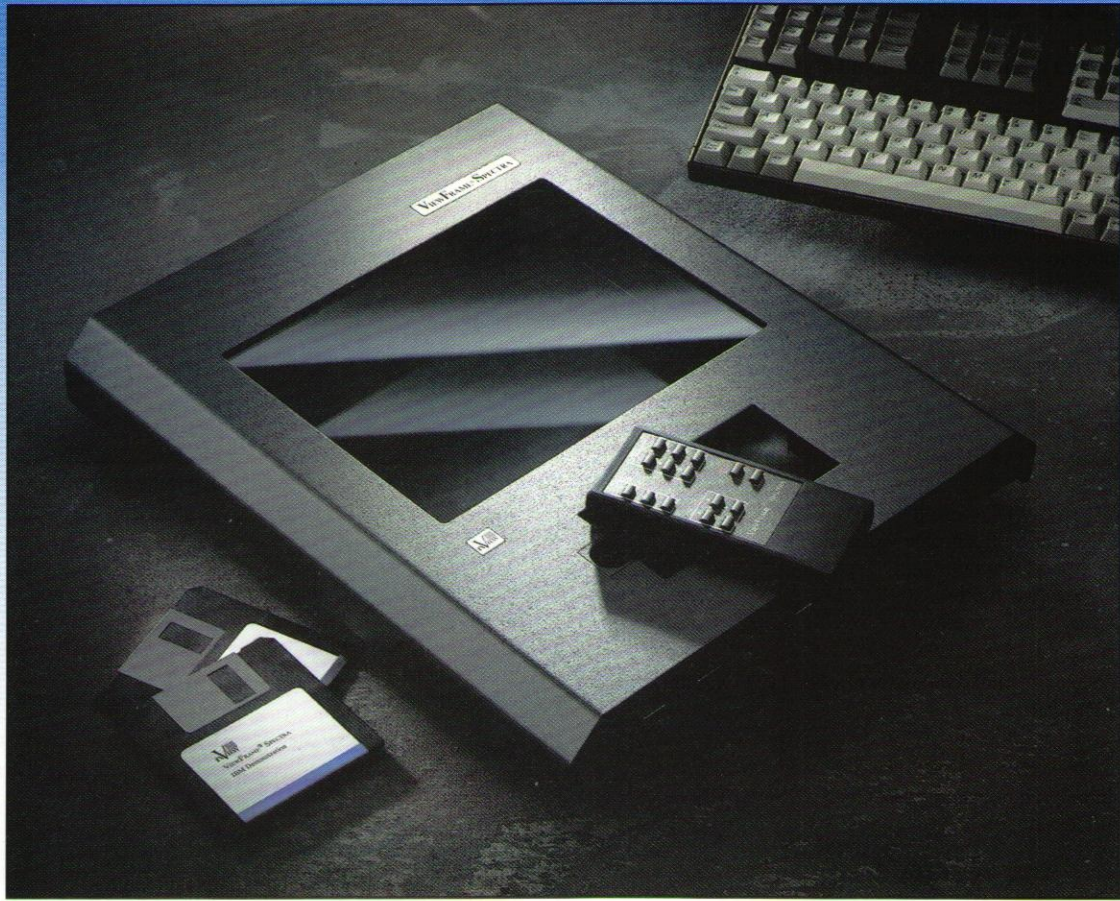

Function

The ViewFrame Spectra is a high-resolution; active-matrix liquid crystal display (LCD) projection panel which projects your personal computer's image in true color. When placed on an overhead projector and connected to a computer, the ViewFrame Spectra acts as an electronic transparency. As a visual aid it is particularly well-suited for business meetings, presentations, and group instruction.

With a range of 4096 colors and an active-matrix LCD, the ViewFrame Spectra projects slide-like images – even animation – in rich, saturated, true color. The use of color in presentations and training vastly increases your audience's interest in and retention of your message. Boardroom quality color, portability, and multi-computer compatibility – the ViewFrame Spectra delivers the most versatile communication solution for your meetings and training sessions.

Features

- 4096 rich, saturated colors for beautiful graphics.
- High contrast ratio for sharp, clear images.
- Ultra-fast refresh rate for crisp animation, transitions, and mouse movement.
- Removable control panel for remote or on-board operation.
- Front or rear projection capability.
- Color and tint control for adjustment to light conditions, projection screen, or individual tastes.
- Screen clear and optional overhead projector power by remote control to maximize audience attention.
- Compatible with most computers.
- Advanced cooling for trouble-free operation.
- Built-in monitor "redrive" amplifier provides simultaneous optional viewing of monitor and projected image.
- Initial adjustments for each video are saved in permanent memory for easy subsequent set up.

ViewFrame[®] Spectra

Technical specifications

The ViewFrame Spectra high-resolution liquid crystal display is compatible with:

- IBM PS/2, PC, AT, XT, and compatible computers.
- Mac II Series.
- Mac Series.
- Apple IIgs.
- Overhead projectors with light source below stage.
- Your current application or graphics software.

Display Type

Active-matrix, Thin Film Transistor Liquid Crystal Display, 640 x 480 pixels.

Display Format

8.31 x 6.24 inches (211.2 x 158.4 mm.)

1.3:1 aspect ratio.

640 x 480 pixels in VGA or Macintosh II video modes.

640 x 400 pixels in CGA or monochrome video modes.

640 x 350 pixels in EGA video mode.

512 x 342 pixels in Macintosh mode.

Controls

Color, Tint, Reset, Focus, Overhead Projector On/Off, LCD On/Off, Palette, Horizontal, Vertical.

Materials

Heavy-gauge aluminum with non-skid rubber feet.
Protective optical surfaces on top and bottom.

Dimensions

14.8 x 12.7 x 2.2 inches (375.9 x 322.6 x 55.9 mm.)

Weight

6.7 pounds (3.04 Kilos.)

Cooling

Patented cooling system uses a metal body, internal fans, and two active air layers to sustain continuous operation.

Power Supply

Wall mount AC/DC converter. U.S. – 110V AC, 60 Hz input; 12V DC output; International – 220V AC, 50 Hz input; 12V DC output.

Temperature

Operating: 0° C to + 40° C; storage: -25° C to +60° C.

Humidity

95% RH max for ambient temp. less than or equal to 40° C.

80% RH max for ambient temp. greater than 40° C.

MTBF (Mean Time Between Failures)

Estimated 10,000 power on hours.

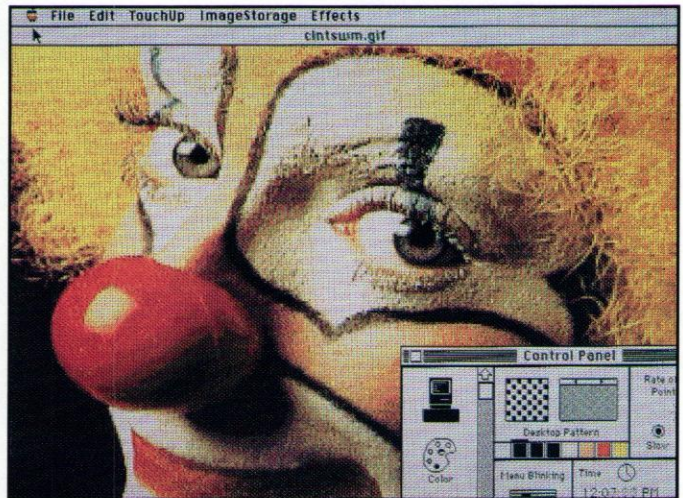

Actual image projected by the ViewFrame Spectra.

Cables

One user-specified cable supplied, 2 meters long and appropriate monitor cable.

DB-9 for EGA, CGA, Mac.

DB-15 for Mac II.

DB-15 high density for VGA (monitor redrive cable not required.)

Demonstration Diskettes

Diskettes in both 3.5 and 5.25 inch formats provide a demonstration program.

Warranty

One year limited warranty on parts and labor.

Packaging

Each ViewFrame Spectra includes manual, demonstration diskettes, U.S. or International power supply, hard shell carrying case, one user-specified cable, and appropriate monitor cable.

Accessories

Additional video interface cables with appropriate redrive cables, Projector Control Kits for overhead projector remote control (U.S. only,) Mac adapter kits.

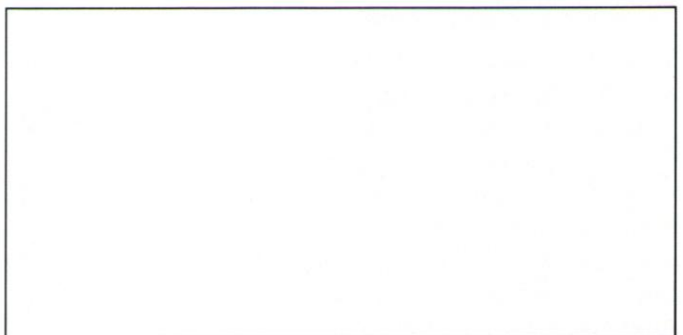

ViewFrame II+2

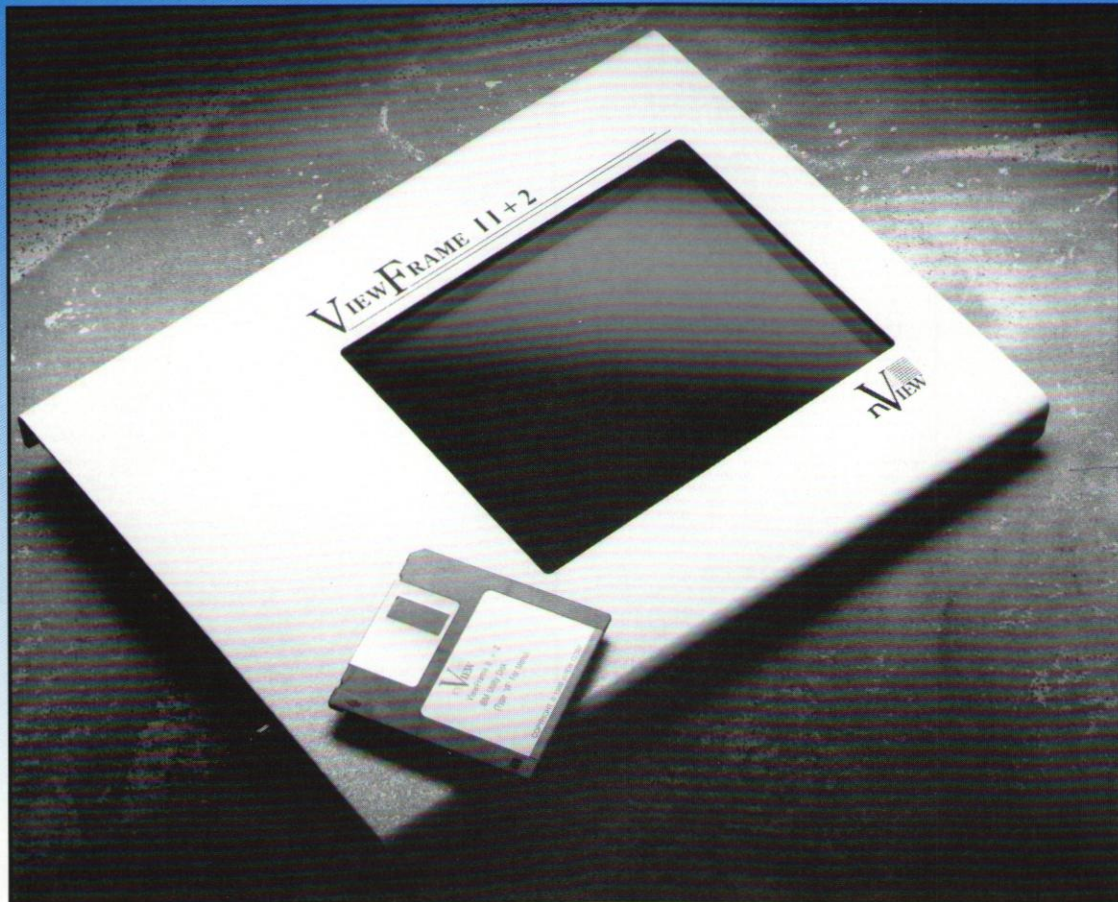

Function

The ViewFrame II+2 is a high-resolution, liquid crystal display (LCD) panel that connects to the video port of your computer and allows projection of computer output onto a large viewing screen. Unlike static transparencies, the ViewFrame II+2 electronic transparency, when connected to a personal computer allows real-time changes during presentations, "hands-on" classroom instruction of all types, and group participation in the preparation or analysis of spreadsheets or other presentation material. As a visual aid it is particularly well-suited for business meetings, sales presentations and group instruction.

Features

Features that make the ViewFrame II+2 your best choice include:

- High contrast ratio for sharp, clear images.
- Advanced cooling system for trouble-free operation.
- Compatibility with most computers.
- Eight true shades of grey for beautiful graphics.
- Special cables allow simultaneous viewing of the monitor and the projected image.
- Works with front and rear screen projection systems.
- Optional remote control available.

ViewFrame II+2

Technical specifications

The ViewFrame II+2 is a high-resolution, liquid crystal display (LCD) panel that works with the following computers:

- IBM PS/2, PC, AT, XT and compatible computers
- Mac 512, Mac Plus, Mac SE, Mac SE/30, Mac II, Mac IIx, Mac IIcx, Mac Portable, Mac Classic, Mac LC
- Apple IIc, Apple IIe, Apple IIgs
- DEC VT 220 and VT 340, AT&T 6300/Olivetti, Atari, Hewlett-Packard, NEC, Tandy and other computers (some of which require special cables)
- all standard overhead projectors with light source below stage
- your current application software

Display Type

Film Super Twist LCD, 640 x 480 pixels, 20:1 contrast ratio. Black-on-white or inverted (white-on-black) image.

Display Format

8.125 x 6.125 inches

1.3:1 aspect ratio

640 x 480 pixels in VGA or Macintosh II video modes.

640 x 400 pixels in CGA or composite video modes.

640 x 350 pixels in EGA video mode.

Controls

Contrast, Image Invert, Horizontal and Vertical position, Focus, Grey Scale or Pixel Pattern, Separate RGB Color Controls for grey scale adjustment.

Materials

Heavy-gauge aluminum with non-skid rubber feet. Protective optical surfaces on top and bottom.

Dimensions

14.8 x 11.4 x 1.3 inches

When placed on an overhead projector, the panel acts as an electronic transparency and allows projection of computer output onto a large screen.



Weight

4.9 lbs. (without cable)

Cooling

Cooling system uses a metal body, an internal fan and two active air layers to sustain continuous operation on a projector with up to 650 watts without damage or adjustments.

Power supply

Wall-mount AC/DC converter. 110V AC, 60Hz Input, 12VDC, 800ma. output, UL/CSA listed. *European (230V AC, 50 Hz Input, 12VDC, 500 ma. output) version is available.

Temperature

Operating: 0° C. to +40° C.; Storage: -20° C. to +50° C.

Humidity

Operating: 10% to 80%; Storage: 10% to 90%

MTBF (Mean time between failures)

10,000 power-on hours

"Y" cables (3 supplied)

DB-9 for EGA, CGA, Mac 512, Plus, SE or SE/30

DB-15 for Macintosh II; Miniature DB-15 for PS/2 or VGA

(Other cables are available at additional cost. All "Y" cables allow simultaneous viewing of monitor and projected image.)

Utility diskettes

Diskettes in both 3.5 and 5.25 inch formats provide utility programs to simplify adjustments for focus and grey scale and to demonstrate the features of the ViewFrame II+2.

Accessories

A form-fitted, hard shell case, three interface cables, wall-mount power supply, utility diskettes and complete instructions are included.

Adapter kits

Required for Mac SE, SE/30, 512, Plus, Classic, and DEC VT 340 terminal. Mac kits install internally with no cutting or soldering. Mac LC requires cable available separately. DEC VT 340 installs internally with some cutting and no soldering. Available separately from nVIEW.

Warranty

One year limited warranty on parts and labor.

TOTEBOARD™

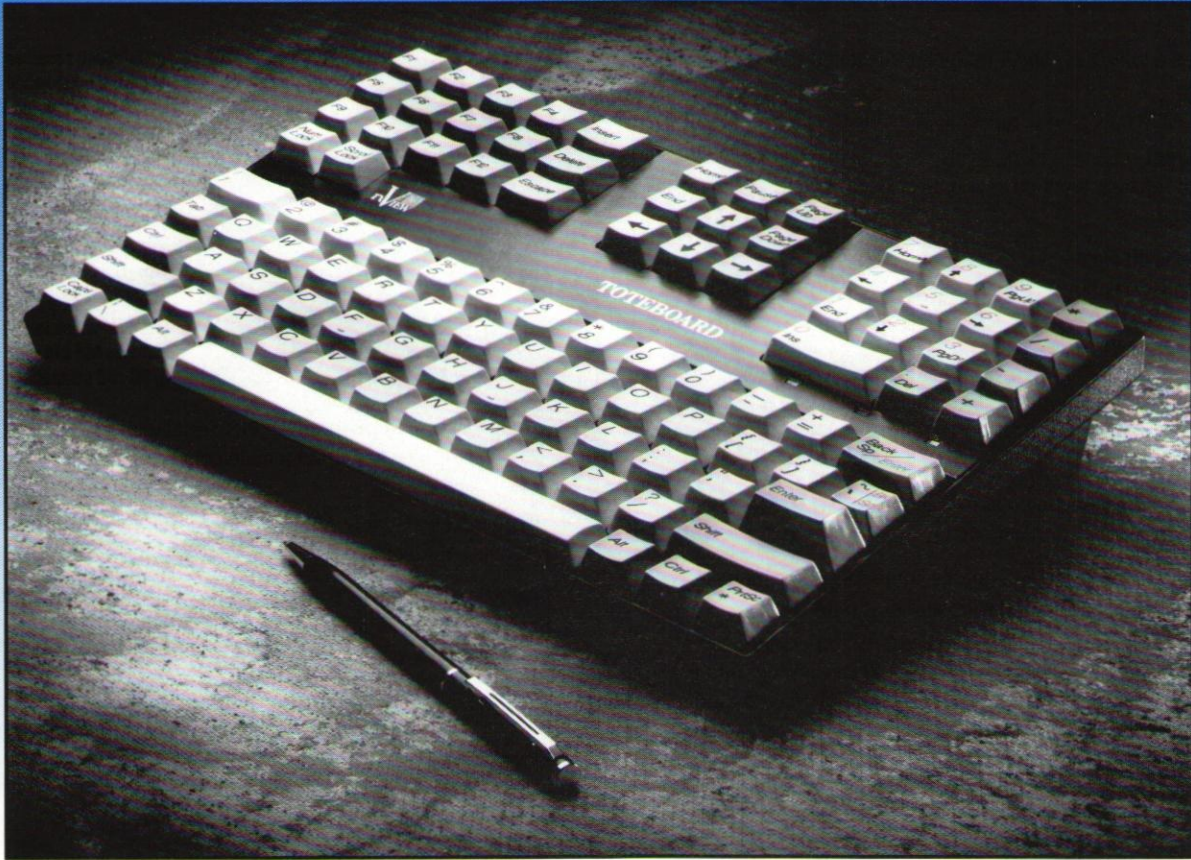

Function

The TOTEBOARD Keyboard is a wireless, small-footprint keyboard that transmits keystrokes via infrared light transmission to the TOTEBOARD Receiver. The Receiver connects by cable to an IBM PC or compatible computer at either the keyboard jack or serial port. The TOTEBOARD keys are a superset of the conventional keyboard with many added capabilities. Use the TOTEBOARD to control computer-based presentations or as a versatile keyboard replacement. Use one TOTEBOARD to run many computers. Use many TOTEBOARDS to address one computer for group participation. The TOTEBOARD is elegantly styled for any executive work area, conference room or classroom.

Features

Features which make the TOTEBOARD Keyboard an excellent choice include:

- Wireless design allows remote control of personal computer.
- Powerful transmitter, sensitive receiver and efficient data encoding overcome distance and directionality problems.
- Comfortable, built-in hand grip for "carry-around" operation.
- Selectable, one-hand operation for convenience or when disabled.
- Small size saves valuable desk space.
- 100 keys, separate numeric and cursor pads.
- Multi-computer control for switching between computer programs.
- Selectable address system for multiple TOTEBOARD environments.
- Turbo rep rate for accelerated key response.

TOTEBOARD™

Technical specifications

The TOTEBOARD is a wireless, small-footprint keyboard that works with the following:

- IBM PS/2, AT, XT, PC and compatible computers

Keyboard Layout

100 keys with separate function keys, cursor control, numeric keypad and typewriter areas.

Keyboard Transmission

Infrared transmission allows you to aim the TOTEBOARD in the general direction of the Receiver, instead of directly at the Receiver as required by most infrared devices. The Receiver uses a special data verification technique to understand transmissions from the Keyboard. Connecting the Receiver to the serial port allows use of both the standard keyboard and the TOTEBOARD Keyboard.

Useable Distance

Up to 30 feet between Keyboard and Receiver.

Controls

- Keyboard—Switches for on/off, double auto-repeat rate, multi-computer mode, one-hand operation and Keyboard address.
- Receiver—Switches for either PC, XT, or AT, PS/2 operation, and Receiver address system. The TOTEBOARD Receiver plugs into the computer keyboard port. An optional serial port interface is available for computers without a detachable keyboard.

Receiver-to-PC Connector Cables (one supplied)

- PC keyboard port connection—PC, XT, AT or compatible with DIN-5 connector; PS/2 or compatible with Mini DIN-6 connector.

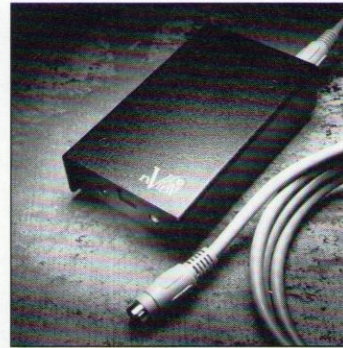

The infrared receiver connects by cable to the keyboard jack or serial port of the computer. It uses a special data verification technique to understand transmissions from the TOTEBOARD. Those transmissions are then relayed to the computer. Connecting the Receiver to the serial port allows use of both the standard keyboard and the TOTEBOARD. It can be used up to 30 feet away from the Receiver, which has selectable switches for use with IBM PS/2, AT, XT, PC and compatible computers.

- PC serial port connection—9 PIN-Serial with DB-9 female connector; 25 PIN-Serial with DB-25 female connector.

Materials

Keyboard: Heavy-duty ABS plastic
Receiver: Aluminum alloy

Dimensions

Keyboard: 10.8 x 6.5 x 2.1 inches
Receiver: 4.3 x 2.5 x 1.2 inches

Weight

Keyboard: 1.4 lbs. (with batteries)
Receiver: .4 lbs. (without cable)

Power Source

Four "AA" batteries (included)
Automatic "sleep" mode ensures battery life for up to one year.

Temperature

Operating: 0°C. to +40°C.; Storage: -20°C. to +50°C.

Humidity

Operating: 10% to 80%; Storage: 10% to 90%

Accessories

Comes with complete instructions and one connector cable, specified upon order (serial port connection cables include a utility diskette). Additional cables and Receivers available from price list.

Warranty

One year limited warranty on parts and labor.

The TOTEBOARD Keyboard has a built-in grip for one-hand use.

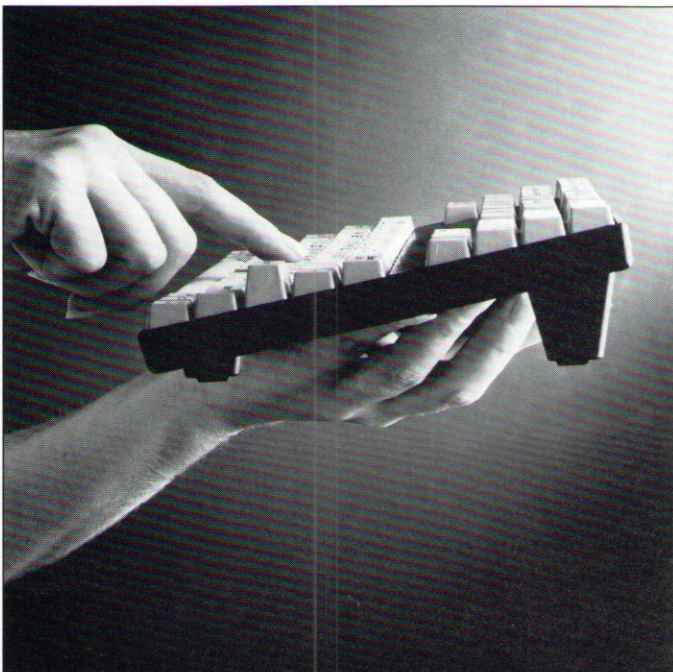

ViewFrame® SpectraPlus



Description

SpectraPlus, which projects in 32,768 colors, is a high-end LCD projection panel for computer users who wish to incorporate scanned color photographs, sophisticated graphics and animation into presentations. SpectraPlus is an ideal tool for computer-based multimedia presentations. SpectraPlus provides smoother shading, more realistic rendering of photos and complex images – including 3-D models – and projects images that are likely to match the colors desired by the presentation's author. SpectraPlus is a less expensive, more portable, easier to operate alternative to three gun CRT data projectors for many computer users.

In addition to more colors than our Spectra model, SpectraPlus incorporates a new contrast control function and high fidelity signal processing, resulting in even better projected images. With its expanded color palette, SpectraPlus is a wise technology investment for PC users as computer graphics cards improve in the future.

SpectraPlus incorporates active-matrix, thin film transistor LCD technology, recognized as technically superior to panels incorporating passive technology because of nView's

ability to project clear animation and moving video images. In addition, active matrix panels combined with nView's proprietary electronics provide more saturation to colors and higher contrast. SpectraPlus provides more than five times more colors than competing passive panels.

Features

- 32,768 rich, saturated, high contrast colors for more realistic rendering of images, improved shading.
- Active matrix, thin film transistor LCD technology allows integration of animation and video images (with a compatible video capture card) into computer presentations.
- Light weight, easy to set-up and use, provides alternative to 3-gun CRT data projectors for computer presentations.
- New high fidelity technology for improved projection image.
- Contrast control function for improved control over screen image.
- Hard carrying case, cables included.
- Compatibility with IBM, Macintosh and many other personal computers.
- Advanced cooling for trouble free operation.

A Gallery of Actual LCD Images

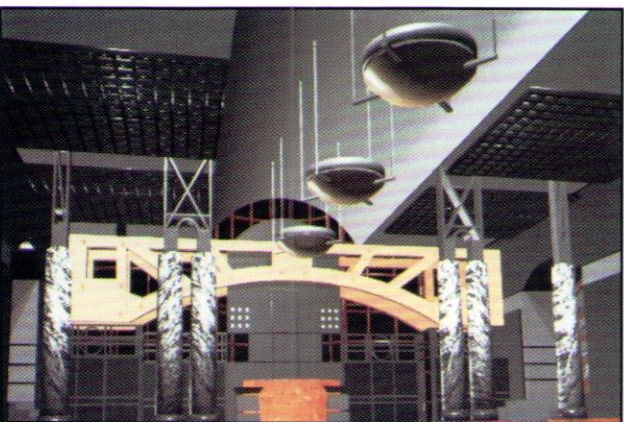
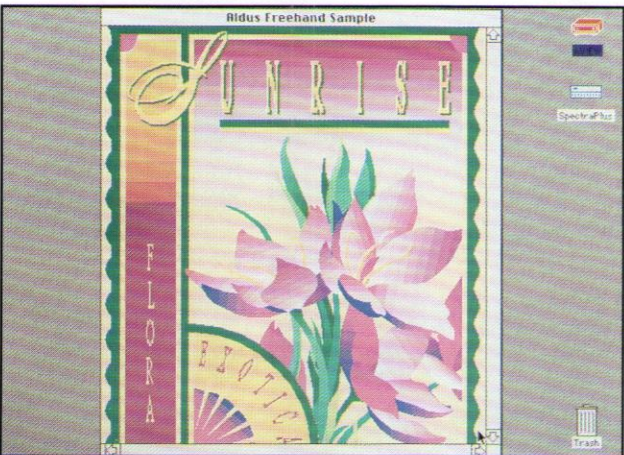
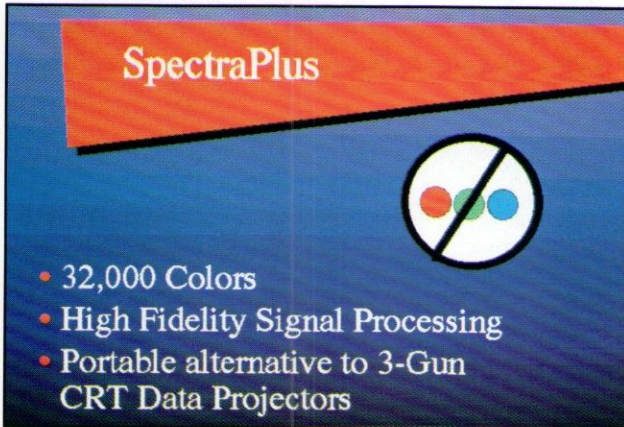

Technical Specifications

The ViewFrame SpectraPlus high-resolution liquid crystal display is compatible with:

- IBM PS/2, PC, AT, XT, and compatible computers.
- Mac II Series, including LC.
- Mac Series.
- Apple II gs.
- Overhead projectors with light source below stage.
- Your current application or graphics software.

Display Type

Active-matrix, Thin Film Transistor Liquid Crystal Display, 640 x 480 pixels.

Display Format

8.31 x 6.24 inches (211.2 x 158.4 mm.)

1.3:1 aspect ratio.

640 x 480 pixels in Super VGA, VGA or Macintosh II video modes.

640 x 400 pixels in CGA or monochrome video modes.

640 x 350 pixels in EGA video mode.

512 x 342 in Macintosh mode.

Controls

Color, Tint, Contrast, Reset, Focus, LCD On/Off, Palette, Horizontal, Vertical, optional Overhead Projector On/Off.

Materials

Heavy-gauge aluminum with non-skid rubber feet. Protective optical surfaces on top and bottom.

Dimensions

14.8 x 12.7 x 2.2 inches (375.9 x 322.6 x 55.9 mm.)

Weight

6.7 pounds (3.04 Kilos.)

Cooling

Patented cooling system uses a metal body, three internal fans, and two active air layers to sustain continuous operation.

Power Supply

Wall mount AC/DC converter. U.S.—110V AC, 60 Hz input; 12V DC output. International—220V AC, 50 Hz input; 12V DC output.

Temperature

Operating: 0° C to +40° C; storage -25° C to +60° C.

Humidity

95% RH max for ambient temp. less than or equal to 40° C.

80% RH max for ambient temp. greater than 40° C.

MTBF (Mean Time Between Failures)

Estimated 10,000 power on hours.

Cables

One user-specified cable included, 2 meters long and appropriate monitor cable. Monitor redrive cable not required for VGA.

DB-9 for EGA, CGA, Mac.

DB-15 for Mac II.

DB-15 high density for VGA.

Demonstration Diskettes

Diskettes in both IBM and Macintosh II formats provide demonstrations of SpectraPlus' capability.

Warranty

One year limited warranty on parts and labor.

Packaging

Each ViewFrame SpectraPlus includes a hard shell carrying case, manual, demonstration diskettes, U.S. or International power supply, one user-specified cable, and appropriate monitor cable.

Accessories

Additional video interface cables with appropriate redrive cables, Projector Control Kits (U.S. only), and Mac adapter kits.